



Healthcare in Europe –

John Dorward

Partnership with Honeywell

HOSPITALS

THE NEW NORMAL

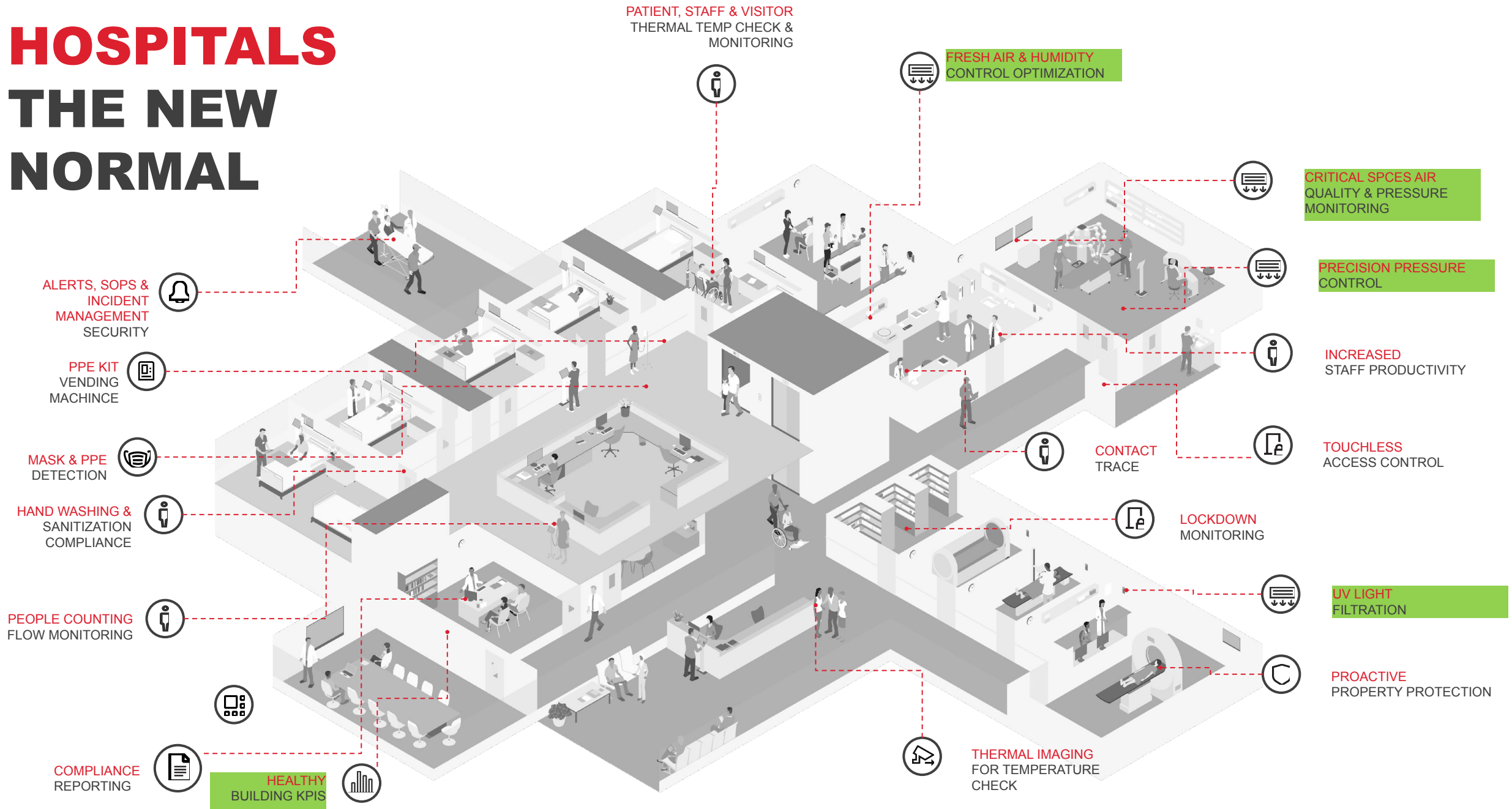

Target architecture to ensure smart buildings able to achieve desired outcomes

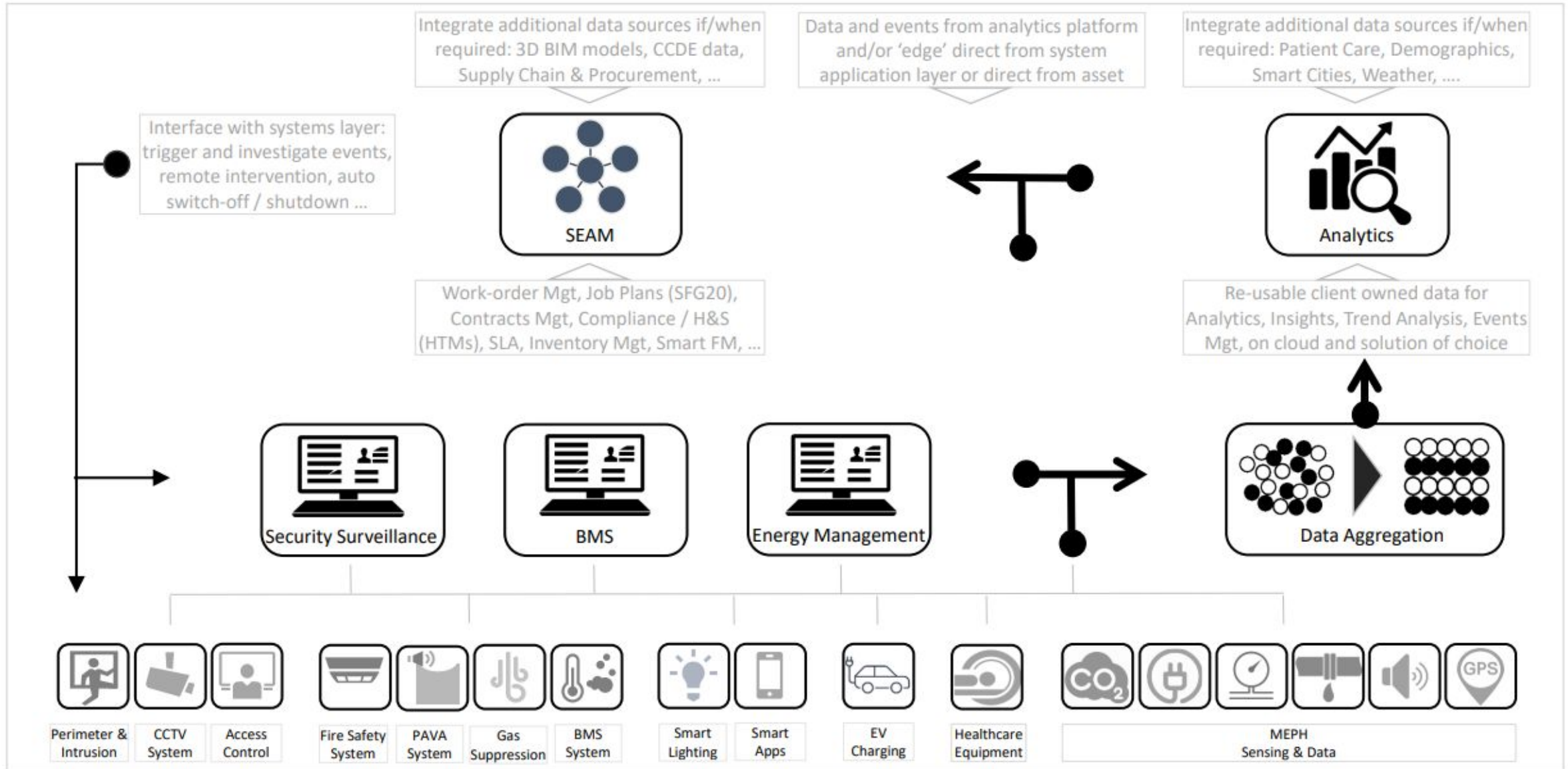

Smart Enterprise Asset Management

SMART OPERATING ROOMS

- Maximise use and efficiency of assets, space, medical equipment and staff
- Tailored patient environment linked to clinical needs
- Environment (CO₂, temp., humidity, IAQ & flow...) impacts on sleeping patterns and overall patient care and recovery
- Energy usage trends by season
- Room occupancy versus energy consumption
- External, socioeconomic factors versus ailments, treatment and length of stay
- Optimise medical and non-medical resource performance.
- Scheduling and capacity planning: appointments, car parking, equipment, etc.

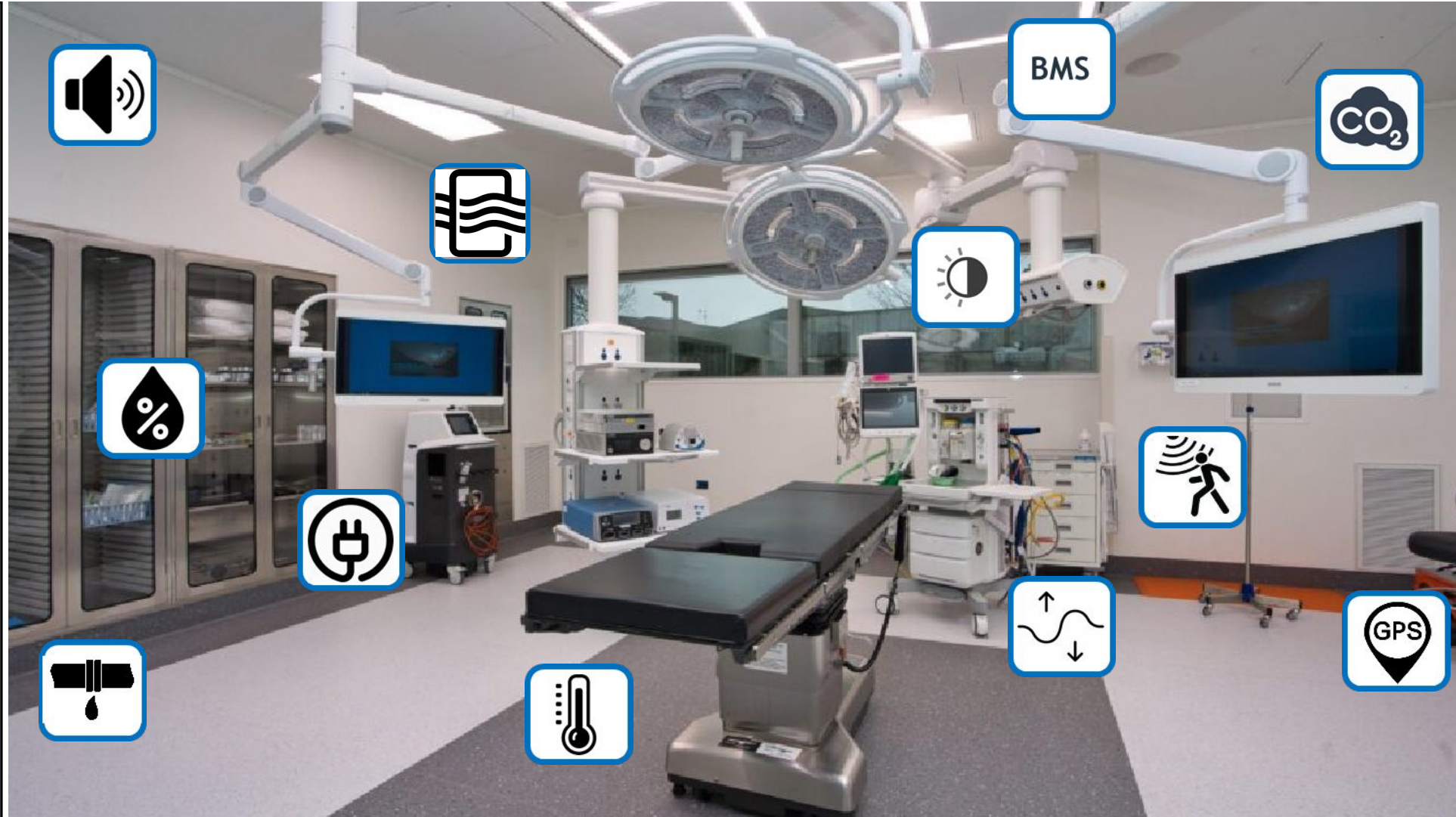

Going Beyond the Basics for Value Added Clinical Solution

Independently Verified Results

AiP's evidence-based data and academic rigour approach vs traditional approach

Advertised

vs

Reality



Ensuring & confirming solutions are fit-for-purpose, cost-effective and aligned with NHP/NHSE strategy

Impartial, 'honest-broker' underpinned by ethical & technical principles

- Govern ethical & technical principles
- Apply to PoC/V and action research projects
- AiP accreditation of projects
- Novate and AiP accredited projects into Trusts and include in future build
- Audit and validate participating partners adhering to principles

- Energy savings and Clinical benefits providing Return on Investment of less than 1 year

Evidence-based data identifying best-practice and feeding into UK Hospital 2.0 new build programmes whilst also replicating across Retained Estate

THANK YOU

